

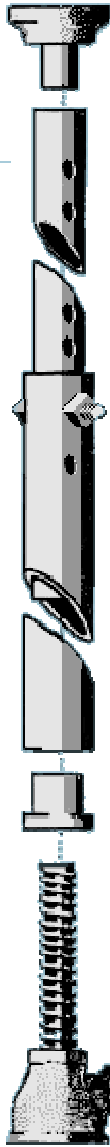

PARTS HEADQUARTERS INC.

1175 APPLEBY LINE, UNIT C2, BURLINGTON, ONTARIO L7L 5H9
TEL: 905-332-3271 FAX: 905-332-9497 TOLL FREE: 1-800-267-2082
INTERNET: www.partshq.com

Column Bars & Clamps



BB9600

Extension 7' – 11'

Column Bar c/w

Ratchet Jack

COL508CA
Bar Clamp

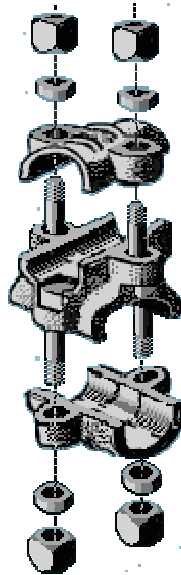

Column Bars and Clamps

COL606X
Swing Dump Clamp

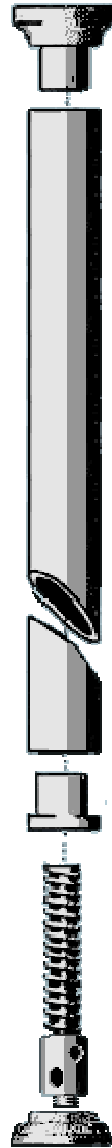
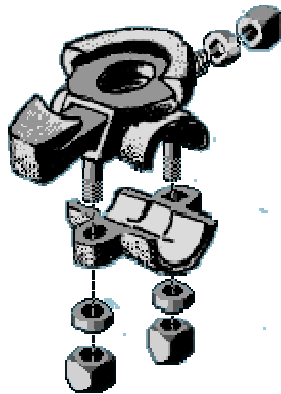

BB9800

Column Bar

Manual Screw



PARTS HEADQUARTERS INC.

1175 APPLEBY LINE, UNIT C2, BURLINGTON, ONTARIO L7L 5H9
TEL: 905-332-3271 FAX: 905-332-9497 TOLL FREE: 1-800-267-2082
INTERNET: www.partshq.com

TOP CAP PRECISION MACHINED TO THE INSIDE DIAM OF THE INNER TUBE AND WELDED TO FIT SQUARELY ON TUBE.

INNER COLUMN BAR FROM SEAMLESS THICK WALL ALLOY STEEL TUBING FOR LONGER LIFE AND PRECISION FIT TO OUTER BAR, GIVES SMOOTH SLIDING AND RIGIDITY AT MAXIMUM EXTENSION.

ONE INCH DIAM HIGH ALLOY BOLT AND COLUMN NUT QUICKLY AND POSITIVELY HOLDS THE INNER EXTENSION TUBE AT VARIED HEIGHTS BETWEEN SEVEN AND ELEVEN FEET. THIS "THROUGH" BOLT LOCKS BOTH TUBES FROM TURNING.

OUTER COLUMN BAR FROM SEAMLESS THICK WALL ALLOY STEEL TUBING FOR LONGER LIFE AND PRECISION FIT TO INNER BAR, GIVES SMOOTH SLIDING AND RIGIDITY AT MAXIMUM EXTENSION. PLUG WELDED ABOVE SCREW TRAVEL KEEPS THE JACKSCREW CLEAN.

HIGH ALLOY COLUMN JACKSCREW NUT PRECISION MACHINED TO FIT INSIDE DIAMETER OF THE OUTER TUBE AND WELDED TO FIT SQUARELY ON TUBE.

JACKSCREW MADE FROM HIGH ALLOY STEEL. RUGGED "BOX" TYPE THREAD GIVES STRENGTH AND LONG WEAR.

A RUGGED AND DEPENDABLE RATCHET TYPE JACKBAR FOR EASY APPLICATION OF MAXIMUM PRESSURE REQUIRED.

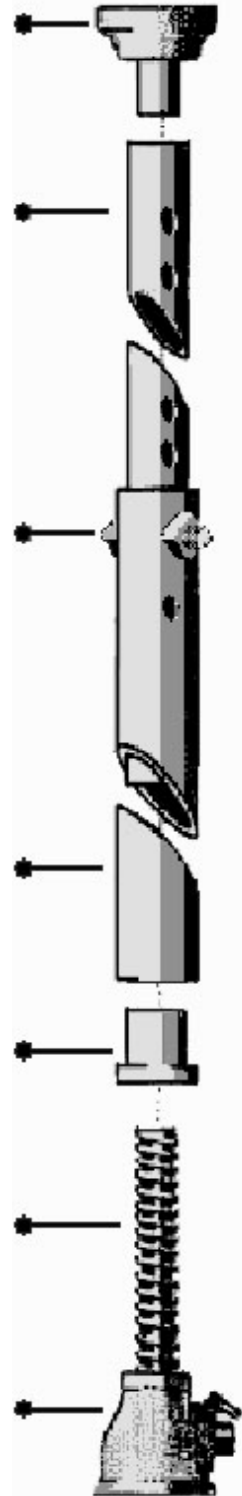



PARTS HEADQUARTERS INC.

1175 APPLEBY LINE, UNIT C2, BURLINGTON, ONTARIO L7L 5H9
TEL: 905-332-3271 FAX: 905-332-9497 TOLL FREE: 1-800-267-2082
INTERNET: www.partshq.com

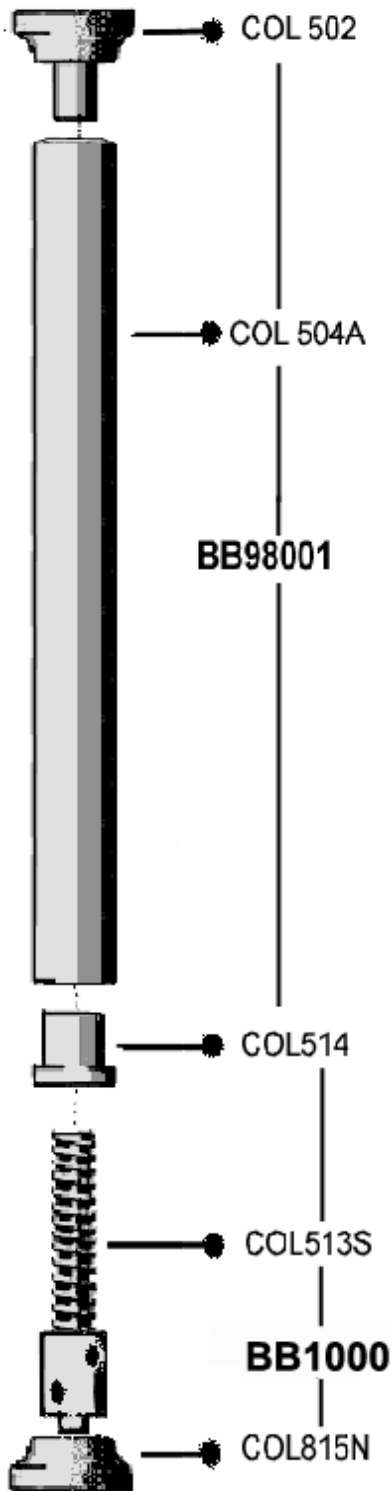

BB9600 STD BAR

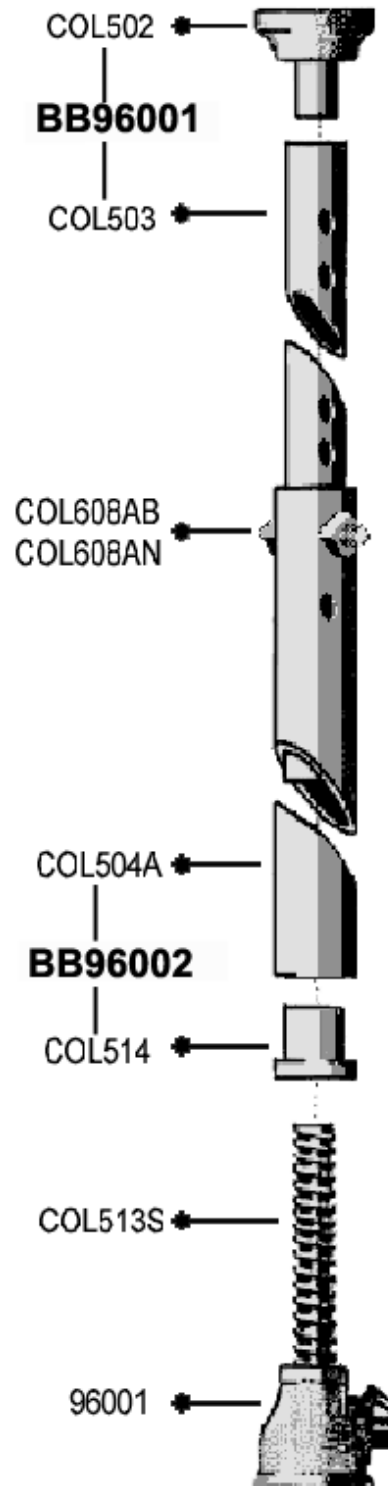

BB9900 EXT BAR



PARTS HEADQUARTERS INC.

1175 APPLEBY LINE, UNIT C2, BURLINGTON, ONTARIO L7L 5H9
 TEL: 905-332-3271 FAX: 905-332-9497 TOLL FREE: 1-800-267-2082
 INTERNET: www.partshq.com

Column Bar Clamps

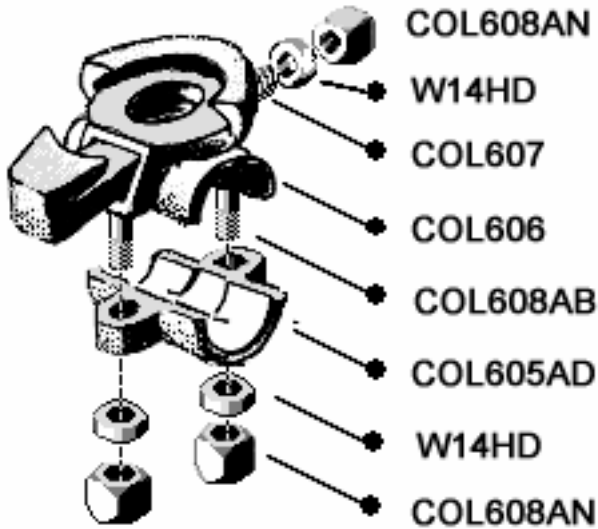

COL606X
Swing Dump Clamp Assembly

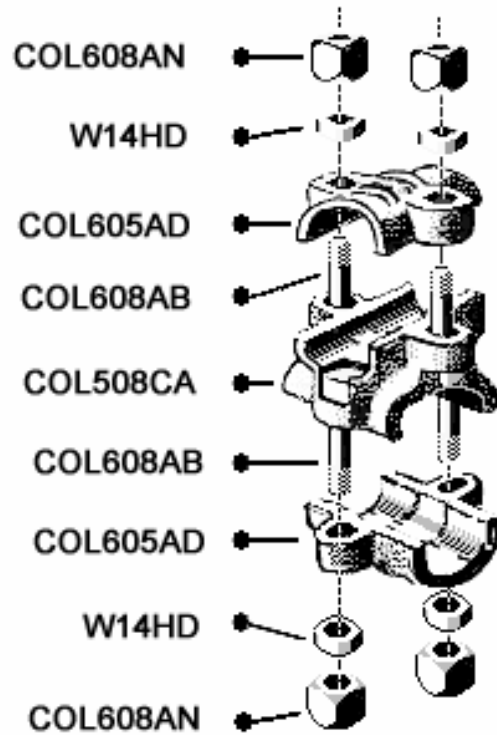

COL608CAX
Universal Clamp Assembly

MANUFACTURED TOUGH!

Parts HeadQuarters column clamps are machined from quality cast steel. The bolts are of grade two steel, and the nuts and the washers are made from higher quality, casehardening, steel for long life. Our tough column parts have been in use in Canadian Mining for over forty years and have proven the most durable and reliable column bar equipment that is available for mounting percussion type long-hole drills and pneumatic diamond drills.



PARTS HEADQUARTERS INC.

1175 APPLEBY LINE, UNIT C2, BURLINGTON, ONTARIO L7L 5H9
 TEL: 905-332-3271 FAX: 905-332-9497 TOLL FREE: 1-800-267-2082
 INTERNET: www.partshq.com

Column Bar

Part No.	Qt'ty	Description	Pricing Can \$	Pricing US\$
COL606X		COLUMN CONE CLAMP SWING DUMP ASSEMBY	\$1,345.00	\$1,170.00
COL606	1	SWING DUMP CLAMP FOR FIVE INCH CONE	\$1,012.50	\$880.00
COL605AD	1	COLUMN ARM CAP (CLAMP)	\$114.00	\$100.00
COL607	1	HOOK BOLT	\$125.95	\$110.00
COL608AB	2	BOLT 1" X 5 1/2"	\$14.00	\$12.20
COL608AN	3	1" CLAMP NUT (1 3/4" SQUARE)	\$16.50	\$14.40
W14HD	3	1" HEAVY DUTY WASHER (NO JOY EQUIV)	\$6.30	\$5.50
COL508CAX		UNIVERSAL COLUMN ARM CLAMP ASSEMBLY	\$634.00	\$550.00
COL508CA	1	UNIVERSAL CLAMP (BARE)	\$258.80	\$260.00
COL605AD	2	COLUMN ARM CAP (CLAMP)	\$114.00	\$100.00
COL608AB	4	BOLT 1" X 5 1/2"	\$14.00	\$12.20
COL608AN	4	1" CLAMP NUT (1 3/4" SQUARE)	\$16.50	\$14.40
W14HD	4	1" HEAVY DUTY WASHER	\$6.30	\$5.50
BB98001		STANDARD COLUMN BAR ASSEMBLY LESS JACK	\$750.00	\$650.00
BB2000		TELESCOPIC COLUMN BAR ASSEMBLY LESS JACK	\$1,210.00	\$1,055.00
BB96002	1	OUTER COLUMN BAR ASSEMBLY	\$825.00	\$720.00
BB96001	1	INNER COLUMN BAR ASSEMBLY	\$604.05	\$525.00
COL608AB	1	BOLT 1" X 5 1/2"	\$14.00	\$12.20
COL608AN	1	1" CLAMP NUT (1 3/4" SQUARE)	\$16.50	\$14.40
BB96002		OUTER COLUMN BAR ASSEMBLY	\$825.00	\$720.00
COL504A	1	OUTER COLUMN PIPE	\$638.00	\$555.00
COL514	1	COLUMN JACKSCREW NUT	\$187.00	\$162.50
BB96001		INNER COLUMN BAR ASSEMBLY	\$605.00	\$530.00
COL503	1	INNER COLUMN PIPE	\$477.00	\$415.00
COL5021	1	TOP CAP	\$127.05	\$110.00
BB1000		MANUAL JACKSCREW ASSEMBY	\$700.00	\$610.00
96000		RATCHET JACK ASSEMBLY C/W HANDLE	\$2,750.00	\$2,400.00
96001		RATCHET JACK ASSEMBLY LESS HANDLE	\$2,400.00	\$2,100.00
BB9900		STANDARD COLUMN BAR C/W BB1000 MAN JACK	\$1,450.00	\$1,270.00
BB9800		STANDARD COLUMN BAR C/W 96000 RAT JACK	\$3,500.00	\$3,050.00
BB9700		TELESCOPIC COLUMN BAR C/W BB1000 MAN JACK	\$2,150.00	\$1,900.00
BB9600		TELESCOPIC COLUMN BAR C/W 96000 RAT JACK	\$4,200.00	\$3,655.00
DMC852		1" NUT 1 5/8" SQUARE (IN PLACE OF COL608AN)	\$20.35	\$17.70
BS200		6" X 1" BOLT (IN PLACE OF COL608AB)	\$19.65	\$17.10